



## PRESSURE RELIEF VALVE

- Lead Free Brass
- Non-Adjustable Pressure Relief Valve Set at 175 psi
- Brass Construction with Rubber Seal
- Designed for use in a sprinkler system where pressure relief is required

## MATERIAL

No.	Part	Material
1	CAP	Brass
2	Washer	Fiber
3	Adjustable Cap	Brass
4	Spring	Stainless Steel
5	Seat Seal	Rubber
6	Seal	Rubber
7	Screw	Rubber
8	Body	Cast Brass

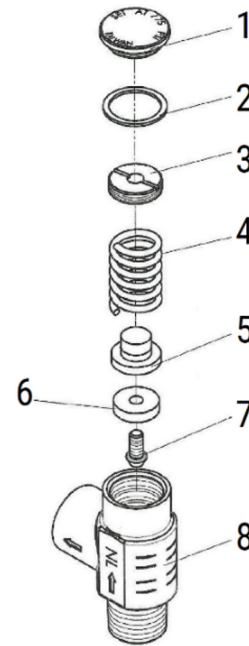

## DIMENSIONS & WEIGHT

Size	Part Number	A (Inch)	B (Inch)	C (Inch)	Weight (oz)
1/2" x 1/2"	90000-190-0000	2.402	0.866	1.142	6.0

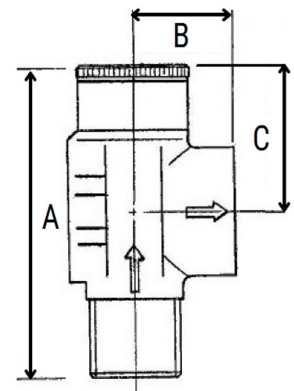

 **WARNING:** Cancer and Reproductive Harm  
[www.p65warnings.ca.gov](http://www.p65warnings.ca.gov)