

## PRESSURE RELIEF VALVE

### FEATURE:

- Made out of Lead-Free Brass
- Non-adjustable pressure relief valve set at 175 psi
- Brass construction with rubber seal
- Designed for use in a sprinkler system where pressure relief is required



### MATERIAL:

No	Part	Material
1	Cap	Brass
2	Washer	Fiber
3	Adjustable Cap	Brass
4	Spring	Stainless Steel
5	Seat Seal	Rubber
6	Seal	Rubber
7	Screw	Brass
8	Body	Cast Brass

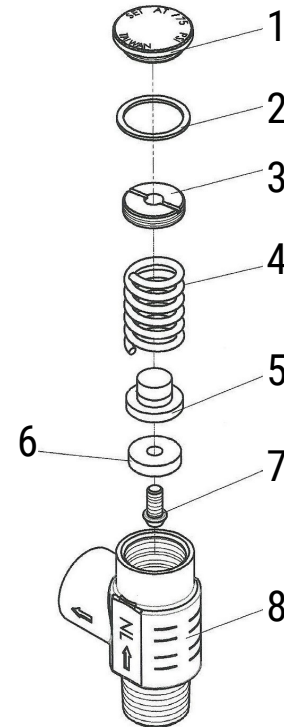

### DIMENSION:

Size	Part Number	A (IN)	B (IN)	C (IN)	Weight (OZ)
1/2" x 1/2" (175 PSI)	90000-190-0000	2.402	0.866	1.142	6.0

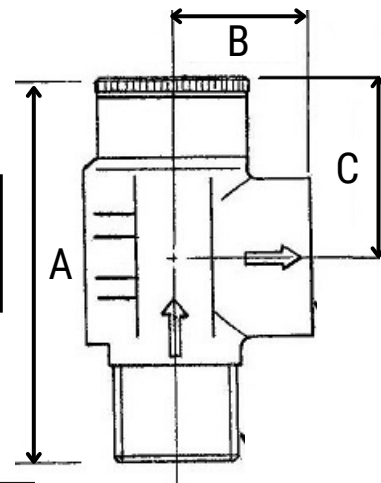

 **WARNING:** Cancer and Reproductive Harm-  
www.P65Warnings.ca.gov